

HELUZ MIAKO clayware ceilings - 350



Use

For a maximum variability of the ceiling structure that does not require technologically demanding installation, maintains a healthy indoor climate and is affordable at the same time.

Semi-mounted MIAKO ceilings are part of a comprehensive system for structural work. They are mostly commonly used in residential and civic buildings, but they may be used in industrial and agricultural buildings as well.

These ceilings are very flexible and can be used in rugged and irregular floor plans of rooms with diameters up to 8 meters. After adding reinforcement, they can also be used as continuous beams or for brackets of balconies and stair landings, for example. However, they are not appropriate for buildings that are dynamically loaded.

Specifications

| | |
|-------------------------------|--|
| Manufacturing plant | JISTROP |
| Dimensions L x W x H (mm) | 3500 x 160 x 175 |
| Average weight inf. | 73,9 |
| Reaction to fire class | Euroclass A1 |
| Fire resistance (EN 1996-1-2) | Ceiling plaster system with 15 mm REI 180 D1 |

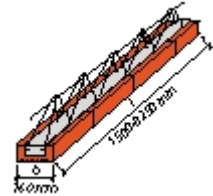

Ceiling thickness 210 mm - max. length of the ceiling beam 6250 mm 6 250 mm

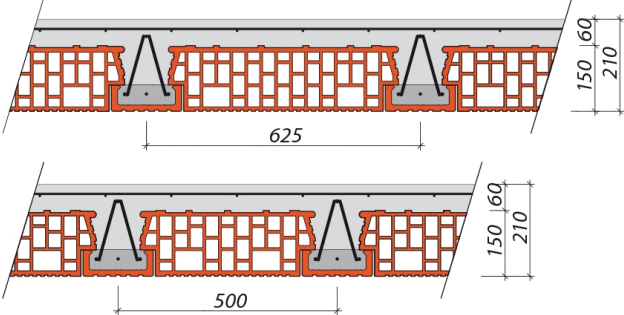

Deckendicke 270 mm

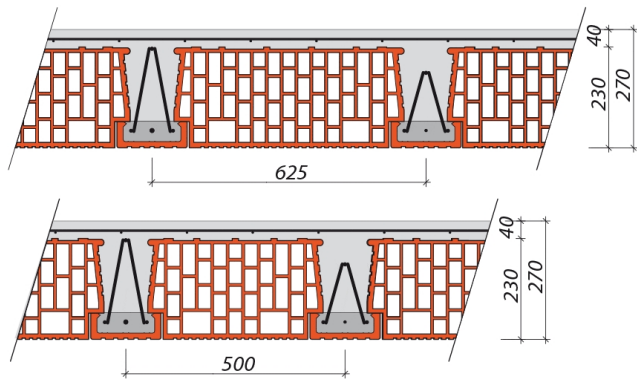

Ceiling thickness 230 mm - max. length of the ceiling beam 6250 mm 6 250 mm

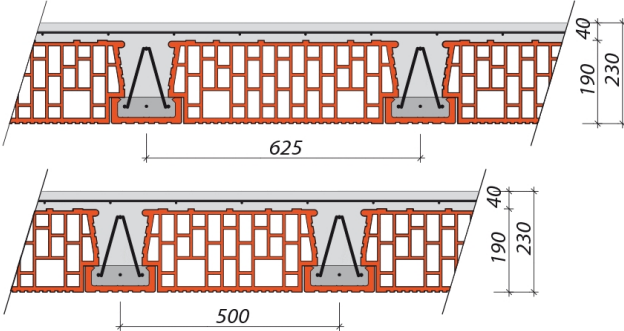

Deckendicke 290 mm

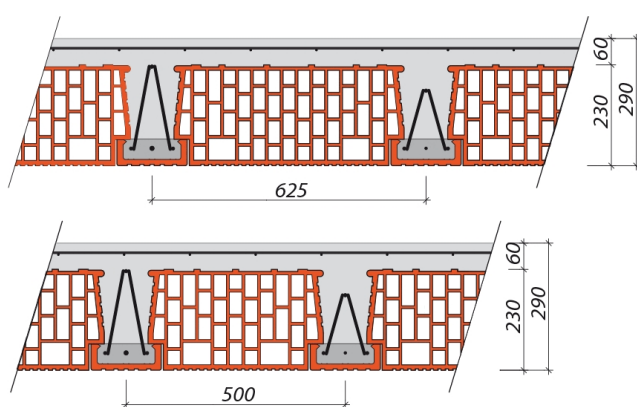

Ceiling thickness 250 mm

